

DDO 14 Dec 90 COPY 107
TO: HWPCD Files
VIA Riggs
13022
RCRA TRNK closure
CINFO



EMD
9

11336/1

To: HWPCD
Did we request
this...
Advised
Col I. 14 Dec 90

State of North Carolina
Department of Environment, Health, and Natural Resources
Wilmington Regional Office

James G. Martin, Governor
William W. Cobey, Jr., Secretary

Bob Jamieson
Regional Manager

DIVISION OF ENVIRONMENTAL MANAGEMENT

November 28, 1990

Brigadier General Michael Downs
Commanding General
United States Marine Corps
Marine Corps Base
Camp Lejeune, North Carolina 28542-5001

Subject: Well Construction Permit No. 66-0234-WM-0211
Building 45
Marine Corps Base
Camp Lejeune
Onslow County

Dear General Downs:

In accordance with your application received November 20, 1990, we are forwarding herewith Well Construction Permit No. 66-0234-WM-0211 dated November 26, 1990, issued to US Marine Corps Base, Camp Lejeune, for the construction of eight (8) monitor wells.

If any parts, requirements, or limitations contained in this Permit are unacceptable to you, you have the right to an adjudicatory hearing before a hearing officer upon written demand to the Director within 30 days following receipt of this Permit, identifying the specific issues to be contended. Unless such demand is made, this Permit shall be final and binding.

This Permit will be effective from the date of its issuance and shall be subject to the conditions and limitations as specified therein.

Sincerely,

A. Preston Howard, Jr. P.E.
Regional Supervisor

APH/RSS/CDR/lfc

Enclosure

cc: Ronald Smith
Perry Nelson
CF, WIRO

CLW

0000005925

NORTH CAROLINA

ENVIRONMENTAL MANAGEMENT COMMISSION

DEPARTMENT OF ENVIRONMENT, HEALTH AND NATURAL RESOURCES

RALEIGH, NORTH CAROLINA

PERMIT FOR THE CONSTRUCTION OF A WELL OR WELL SYSTEM

In accordance with the provisions of Article 7, Chapter 87, North Carolina General Statutes, and other applicable Laws, Rules and Regulations.

PERMISSION IS HEREBY GRANTED TO

US Marine Corps

FOR THE CONSTRUCTION OF eight (8) monitor wells, which will be exposed to the Surficial Aquifer, and which will be located on NC 24, Building 45, Camp Lejeune, Onslow County, in accordance with the application dated November 19, 1990, and in conformity with specifications and supporting data, all of which are filed with the Department of Environment, Health and Natural Resources and are considered a part of this Permit.

This Permit is for well construction only, and does not waive any provisions or requirements of the Water Use Act of 1967, or any other applicable laws or regulations.

Construction of a well under this Permit shall be in compliance with the North Carolina Well Construction Regulations and Standards, and any other laws and regulations pertaining to well construction.

This Permit will be effective from the date of its issuance until May 27, 1991, and shall be subject to other specified conditions, limitations, or exceptions as follows:

1. The well(s) shall be located and constructed as shown on the attachments submitted as part of the permit application.

Permit issued this the 26th day of November 1990.

NORTH CAROLINA ENVIRONMENTAL MANAGEMENT COMMISSION

A. Preston Howard, Jr., P.E., REGIONAL SUPERVISOR
Division of Environmental Management

By Authority of the Environmental Management Commission

PERMIT NO. 66-0234-WM-0211

CLW

000005926

66-0244-0000

NORTH CAROLINA
ENVIRONMENTAL MANAGEMENT COMMISSION
DEPARTMENT OF NATURAL RESOURCES AND COMMUNITY DEVELOPMENT
APPLICATION FOR PERMIT TO CONSTRUCT MONITOR/RECOVERY WELL(S)

To: NORTH CAROLINA ENVIRONMENTAL MANAGEMENT COMMISSION 11/19, 1990

Gentlemen:

In accordance with the provisions of Article 7, Chapter 87, General Statutes of North Carolina, and regulations pursuant thereto, application is hereby made by U. S. MARINE CORPS - CAMP LEJEUNE (name of well owner) for a permit to construct a monitor/recovery well(s) as described below and in the accompanying data submitted as a part of this application.

- (a) Name of property owner: U. S. MARINE CORPS
- (b) Location of property: N.C. 24 - BUILDING 45 - CAMP LEJEUNE - ONSLOW
(Road, Industry, Community, etc.) Town County
- (c) Type of facility or site being monitored: Abandoned FUEL OIL STORAGE TANK
- (d) Types of contamination being monitored or recovered: _____
- (e) Existing monitor well numbers: NONE
- (f) Existing monitor wells showing contamination (well no.): NONE
- (g) Estimated water-table depth: 10 feet
- (h) Estimated date of construction: Begin 11/27/90 Complete 11/30/90
- (i) Drilling contractor: Law Engineering - N.C. REG. # 332
- (j) Location of well: Provide a detailed map showing the location of the proposed well(s), and of any wells in an existing monitoring system (if applicable), in relation to the pollution source(s) being monitored and to at least two (2) nearby permanent reference points such as roads, intersections, and streams. Identify roads with State Highway road identification numbers. (Show all existing water supply wells within a radius of 1,000 feet of the proposed well.)
- (k) Well construction diagram: Provide a diagram showing proposed construction specifications, including diameter, estimated depth, screens, sand pack, grout, type of materials, etc.
- The Applicant hereby agrees the proposed well will be constructed in accordance with approved specifications and conditions of the Well Construction Permit. As regulated under the Well Construction Standards (Title 15 - North Carolina Administrative Code, Subchapter 2C)
- U.S. MARINE CORPS
CAMP LEJEUNE NC 28546
(Mailing Address of Well Owner-Required)
DEWBERRY & DAVIS
523B Valleypointe Parkway
(Mailing Address of Agent-If other than above)
suite 113 Roanoke Va. 24019
- Ronald B. Smith
Signature of Agent or Agent
Engineer
Title (if applicable)
- FOR OFFICE USE ONLY
PERMIT NO. _____ Issued _____ 19____

GW-228

CLW

000005927

NORTHEAST CREEK

OIL SUBSTATION

NO. 24

TELEPHONE

RAILROAD

MIDWAY PARK WASTE OIL STORAGE TANK

OLW

000005928

FUELING PAD
WASH PAD

PUBLIC WORKS BLDG.

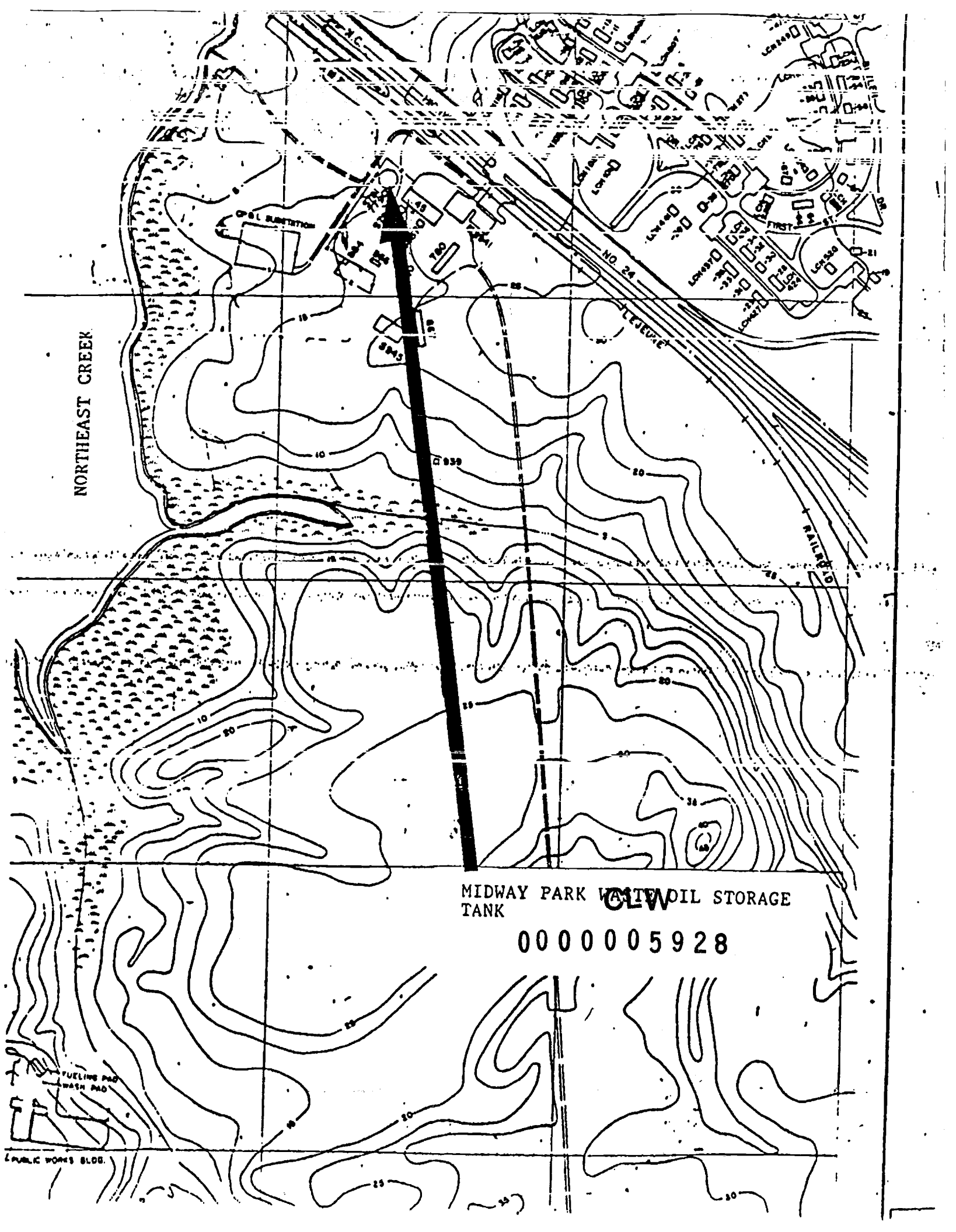

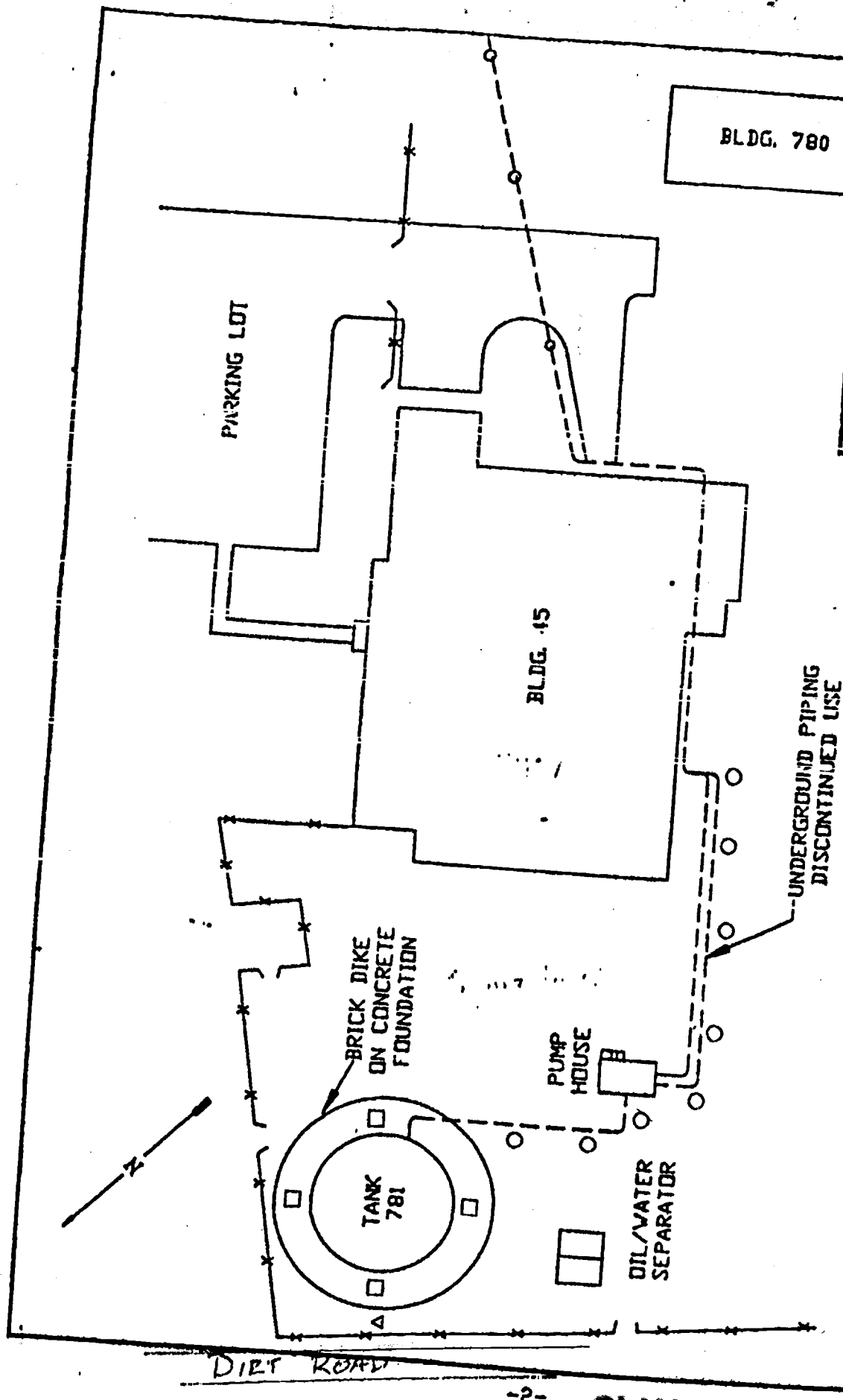

Environmental and Safety Designs, Inc.
ENSAFE®
 5705 STAGE 4E HIGHWAY IN 28131 40823372-7742

FIGURE 1
USED OIL STORAGE
TANKS MIDWAY PARK

- - DRILL LOCATIONS:
 B - ANTICIPATED
 □ - HAND AUGERS
 △ - ANTICIPATED
 △ - Monitor Wells -
 2 REQUIRED -
 20' Deep
- NOT TO SCALE

NOTE: TANK IS 40FT. V/ 200,000 GAL. CAPACITY
 NOTE: DIKE IS 68FT. X 4/5FT. HIGH

Locking Cap

Steel Outer Casing
(If plastic inner casing)

Land

Surface

Neat Cement Grout

Well Casing
(2" or larger diam.)
SCHEDULE 40

Pelletized Bentonite

Clean Washed
Sand or Gravel

Well Screen

2 ft.

2 ft.

1.5 ft.

3-7 ft.

1" BENTONITE

2" SAND

10 ft.

NOTE:

1. Borehole to be six inches larger than outside diameter of casing.
2. Casing and screen to be centered in borehole.
3. Top of well screen should not be above mean high season^{al} water level.
4. Casing and screen material to be compatible with type of contaminant being monitored.
5. Well head to be labeled with highly visible warning saying: "Well is for monitoring and not considered safe for drinking."
6. Well to be afforded reasonable protection against damage after construction.

CLW

000005930

CAMP LEJEUNE
BUILDING 45

GWS 10/84