

01.01 - 5/27/94 - 00625



INSTALLATION RESTORATION

UNITED STATES MARINE CORPS
ENVIRONMENTAL MANAGEMENT DEPARTMENT
MARINE CORPS BASE
CAMP LEJEUNE, NORTH CAROLINA



ATTN: LINDA BERRY

FAX#: (804) 322-4805

FROM: WALTER T. HAVEN (GEOLOGIST)

COMMENTS: COMMENTS FROM DRAFT FINAL HASP AND
SI PLANS FOR SITES A, 12, 68, 75, 76, 84, & 85.
THANK YOU.

-WALT.

IF THERE IS A PROBLEM WITH THIS TRANSMISSION, PLEASE CALL (919)
451-5063/5068, EXT 404 (DSN 484-5063). OUR FAX NUMBER IS (919)
451-1164 (DSN 484-1164).

Revised: 4-21-94

DRAFT FINAL
SITE INSPECTION
HEALTH AND SAFETY PLAN FOR
SITES A, 12, 68, 75, 76, 84, AND 85
MARINE CORPS BASE
CAMP LEJEUNE, NORTH CAROLINA

CONTRACT TASK ORDER 0193

APRIL 21, 1994

Prepared For:

DEPARTMENT OF THE NAVY
ATLANTIC DIVISION
NAVAL FACILITIES
ENGINEERING COMMAND
Norfolk, Virginia

Under the:

LANTDIV CLEAN Program
Contract N62470-89-D-4814

Prepared By:

BAKER ENVIRONMENTAL, INC.
Coraopolis, Pennsylvania

Draft Final

Site Inspection Health and Safety Plan
Sites A, 12, 68, 75, 76, 84, and 85
Marine Corps Base, Camp Lejeune, North Carolina
~~Portsmouth, Virginia~~

SPINE OF
 BINDER



FOSTER WHEELER



DRAFT FINAL
SITE INSPECTION
WORK PLAN
FOR
SITES A, 12, 68, 75, 76, 84, AND 85
MARINE CORPS BASE
CAMP LEJEUNE, NORTH CAROLINA

CONTRACT TASK ORDER 0193

APRIL 21, 1994

Prepared For:

DEPARTMENT OF THE NAVY
ATLANTIC DIVISION
NAVAL FACILITIES
ENGINEERING COMMAND
Norfolk, Virginia

Under:

LANTDIV CLEAN Program
Contract N62470-89-D-4814

Prepared by:

BAKER ENVIRONMENTAL, INC.
Coraopolis, Pennsylvania

193323WP

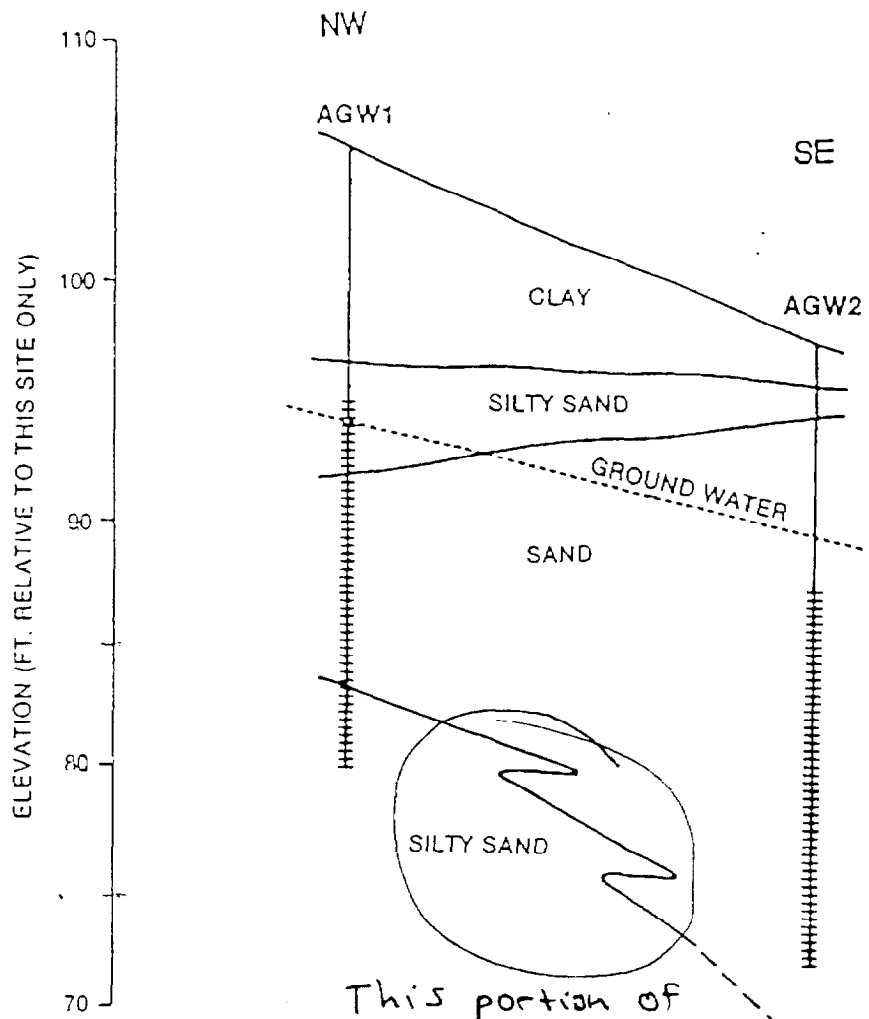

LEGEND

AGW1



EXISTING SHALLOW MONITORING WELL

Add contact ~~to~~ boundaries to legend.



HORIZONTAL SCALE



FIGURE 2-5
 GEOLOGIC CROSS-SECTION
 SITE A
 MCAS OFFICER'S HOUSING AREA
 SITE INSPECTION CTO-0193
 MARINE CORPS BASE, CAMP LEJEUNE
 NORTH CAROLINA

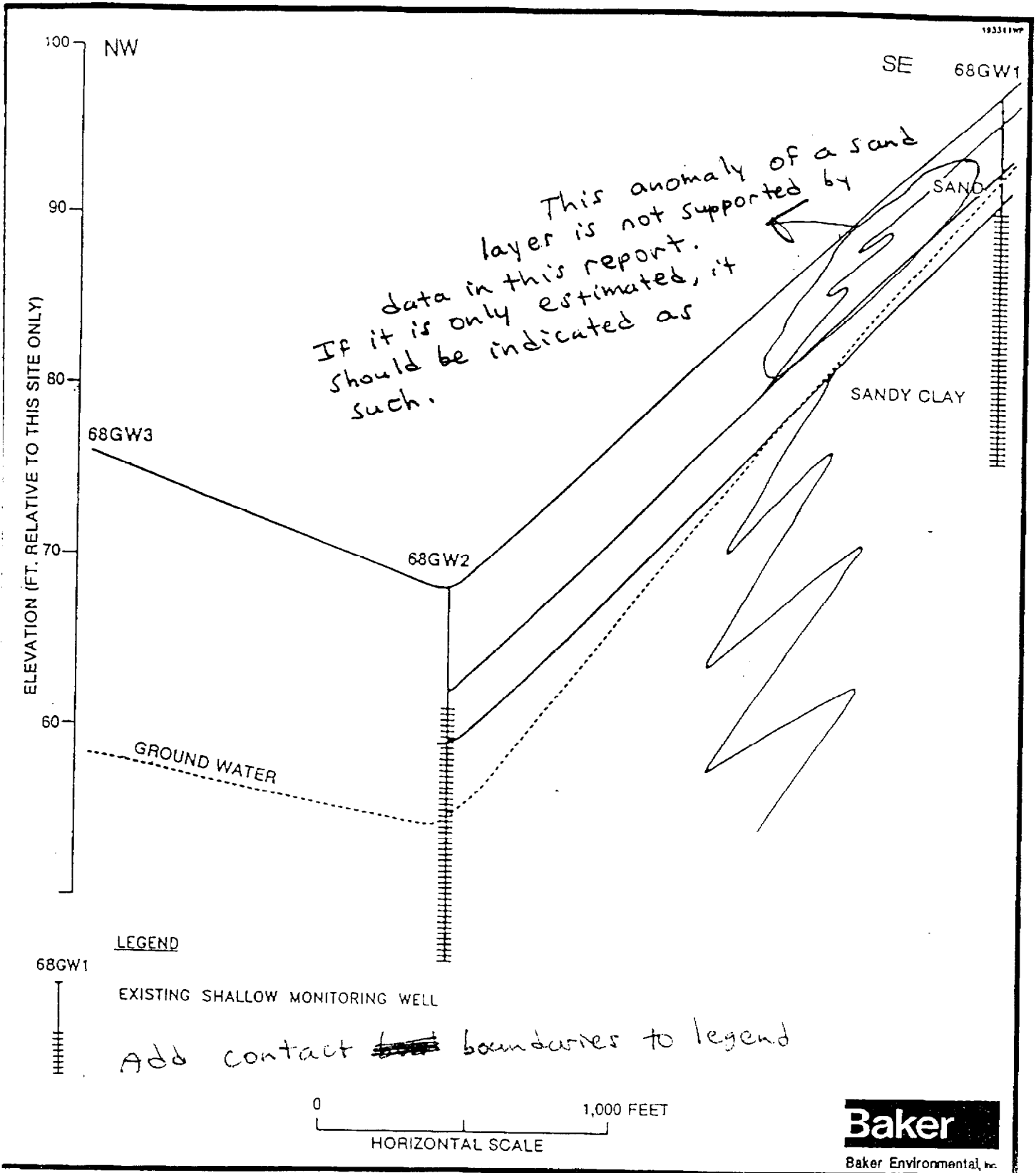
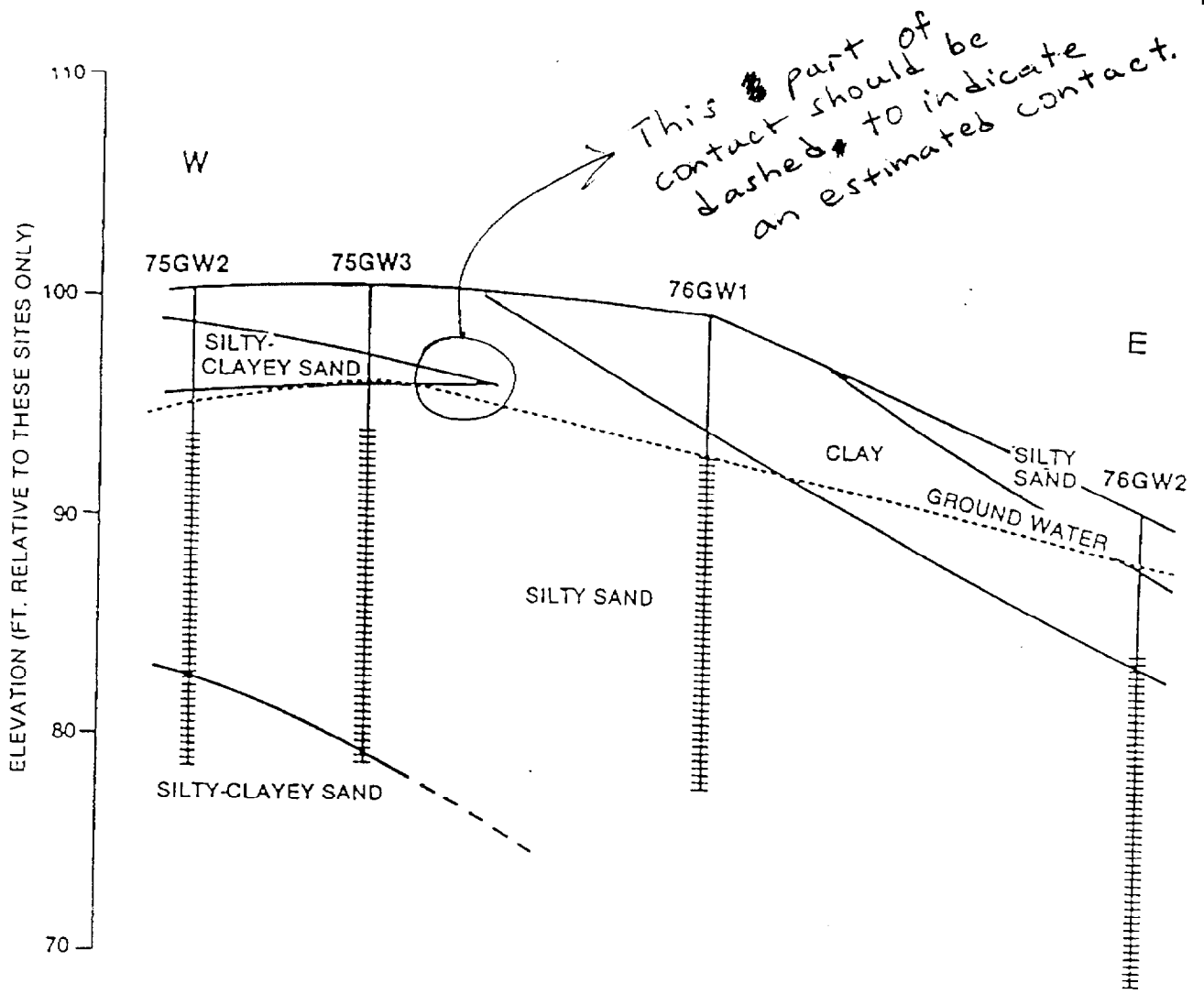

FIGURE 2-8
 GEOLOGIC CROSS-SECTION
 SITE 68
 RIFLE RANGE DUMP
 SITE INSPECTION CTO-0193
 MARINE CORPS BASE, CAMP LEJEUNE
 NORTH CAROLINA

19351297



LEGEND

75GW2



EXISTING SHALLOW MONITORING WELL

Add contact boundaries to legend.

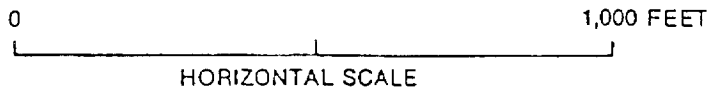

Baker Environmental, Inc.

FIGURE 2-10
 GEOLOGIC CROSS-SECTION
 SITES 75 and 76
 MCAS BASKETBALL COURT
 SITE INSPECTION CTO-0193
 MARINE CORPS BASE, CAMP LEJEUNE
 NORTH CAROLINA

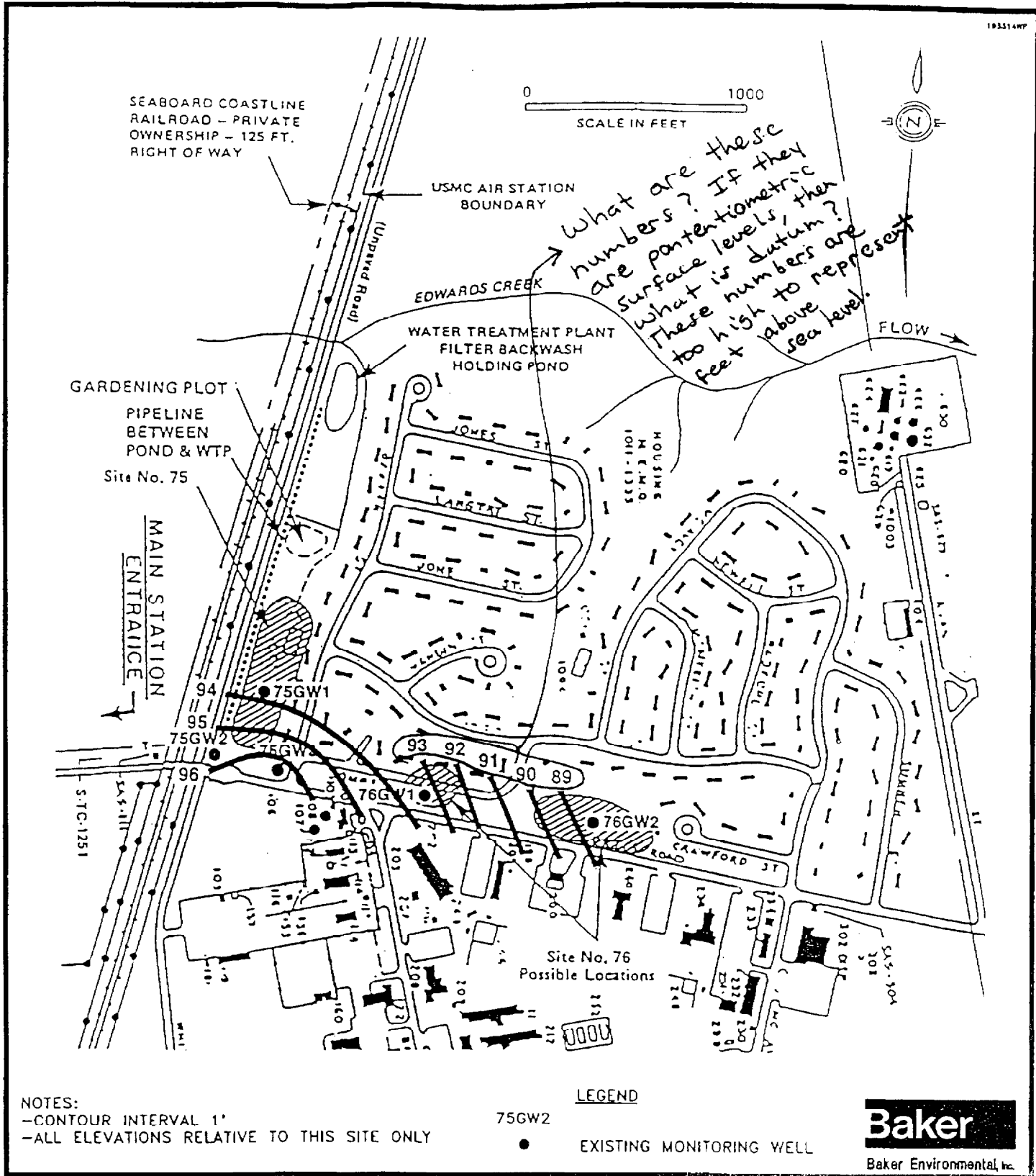

NOTES:
 -CONTOUR INTERVAL 1'
 -ALL ELEVATIONS RELATIVE TO THIS SITE ONLY

LEGEND
 75GW2
 ● EXISTING MONITORING WELL



FIGURE 2-11
 GROUNDWATER CONTOUR MAP-SHALLOW AQUIFER
 SITES 75 and 76
 MCAS BASKETBALL COURT
 SITE INSPECTION CTO-0193
 MARINE CORPS BASE, CAMP LEJEUNE
 NORTH CAROLINA